

6

5

4

3

2

1

GENERAL MACHINING TOLERANCE - GRADE MEDIUM (UNI EN ISO 22768)													REMOVE SHARP EDGES TOGLIERE SPIGOLI VIVI		
TOLLERANZA GENERALE DI LAVORAZIONE - GRADO MEDIO (UNI EN ISO 22768)															
Size	above	Gruppo di dimensioni	oltre	-	6	30	120	400	1000	2000	4000	Chamfer Smusso	0.5x45° R=0.5		
	up to		fino a	6	30	120	400	1000	2000	4000					
Tolerance	Scostamenti			±0.1	±0.2	±0.3	±0.5	±0.8	±1.2	±2	±3				

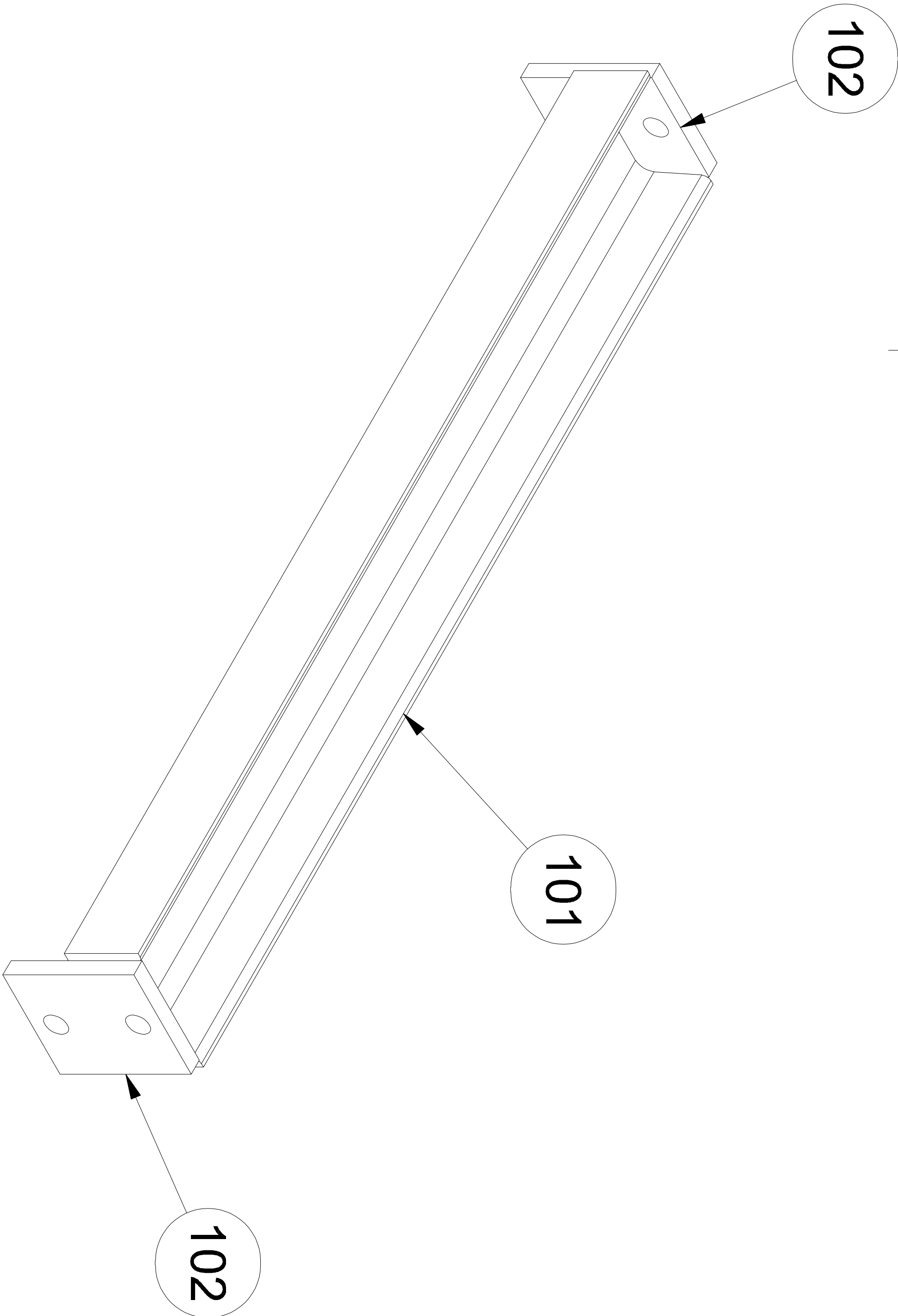
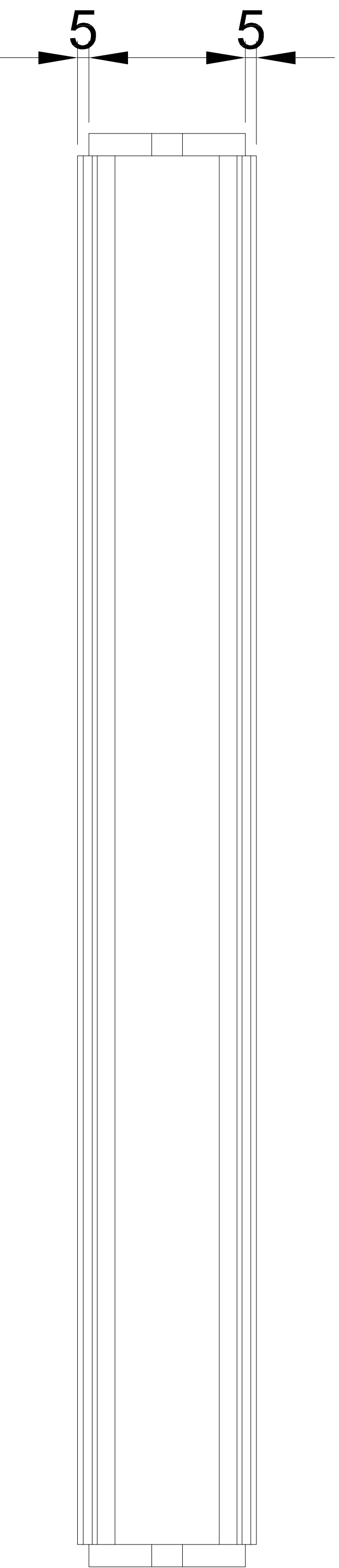
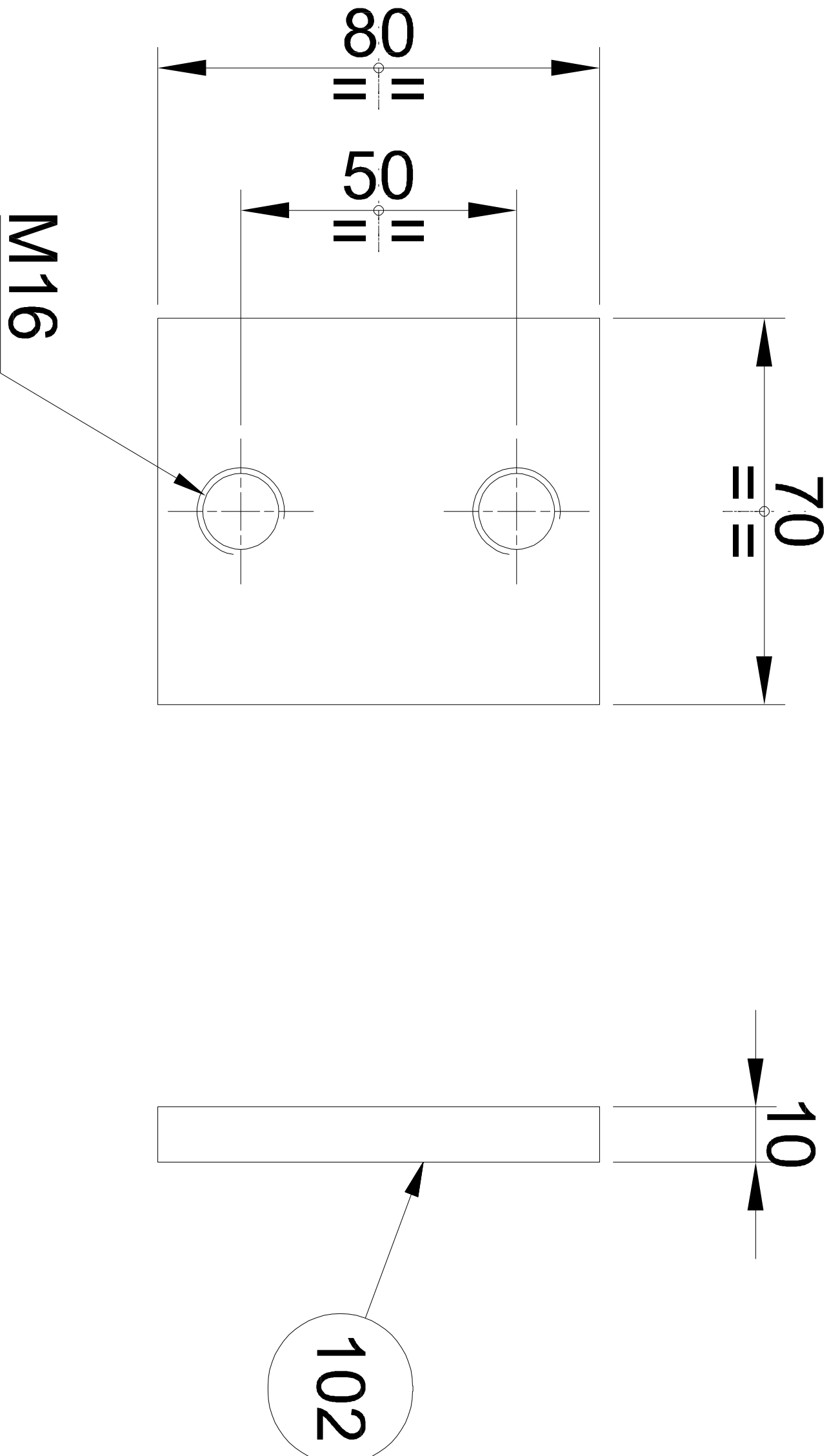
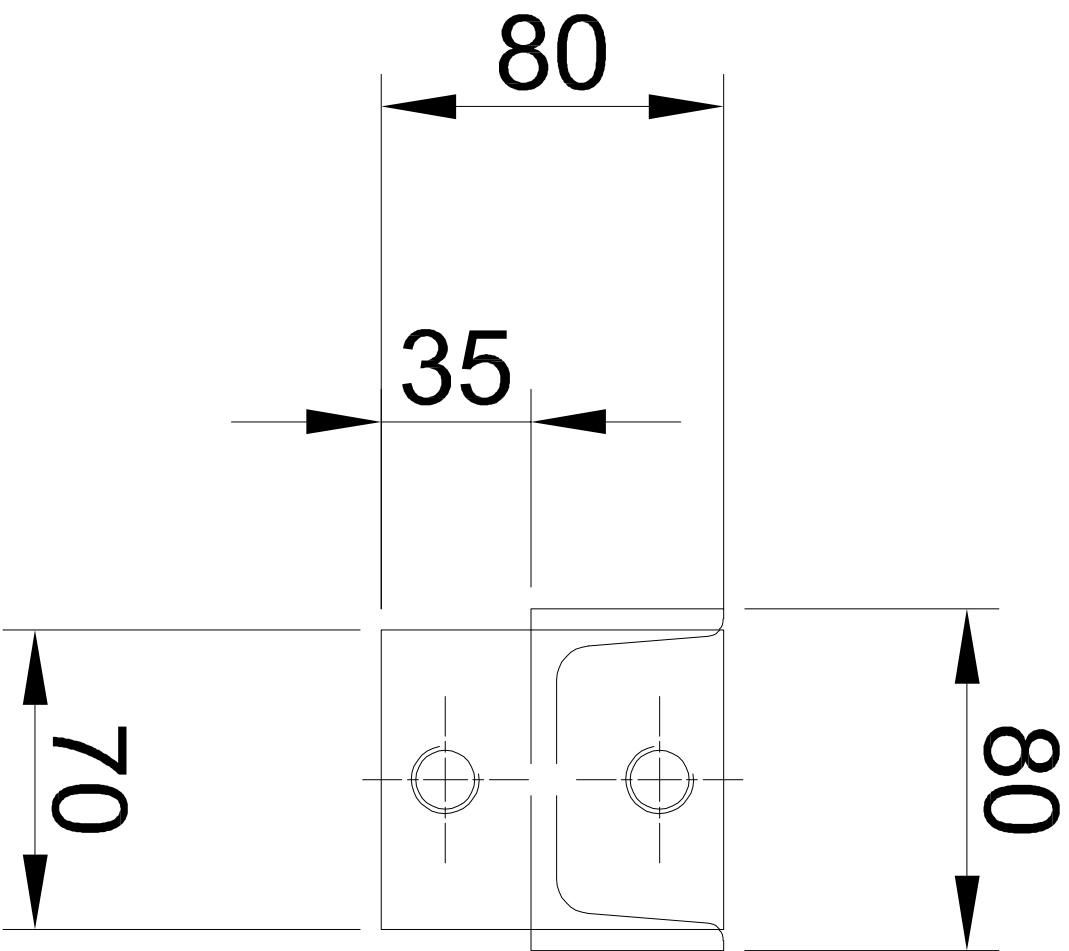
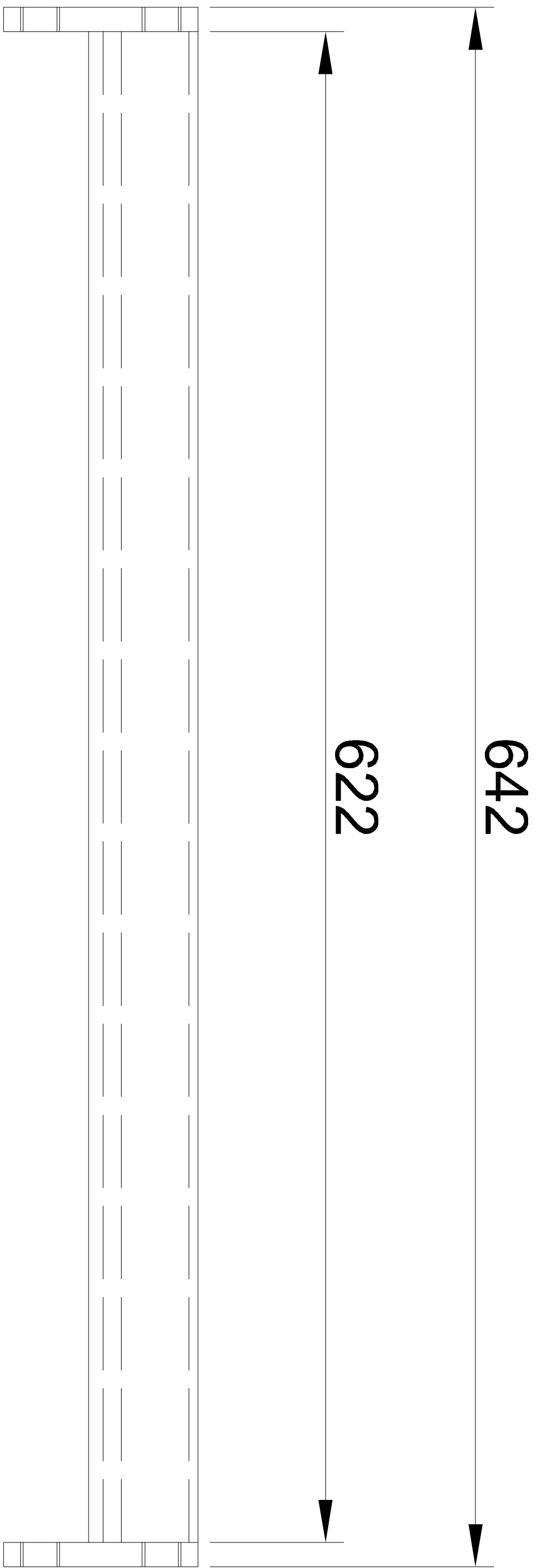

PAINTING STANDARDS

Paint the unworked surfaces as indicated:
- n°1 layer of Inorganic Zinc. thickness 75µm.
- n°1 or more layers of two-component epoxy paint, thickness 175µm.
The thickness of the final layer will therefore be no less than 250µm.

RAL

6

5

4

3

2

1

NORME GENERALI DI SALDATURA GENERAL RULES FOR WELDED JOINTS

PREPARAZIONE DEI LEMBI SECONDO "DIN 1912"
EDGE PREPARATION FOR WELDING ACCORDING TO

DOVE NON ALTRIMENTI INDICATO - A = 0.7
DELLO SPESSORE MINIMO DA COLLEGARE
WHERE NOT SPECIFIED - A = 0.7
OF THE MINIMUM THICKNESS TO BE JOINT

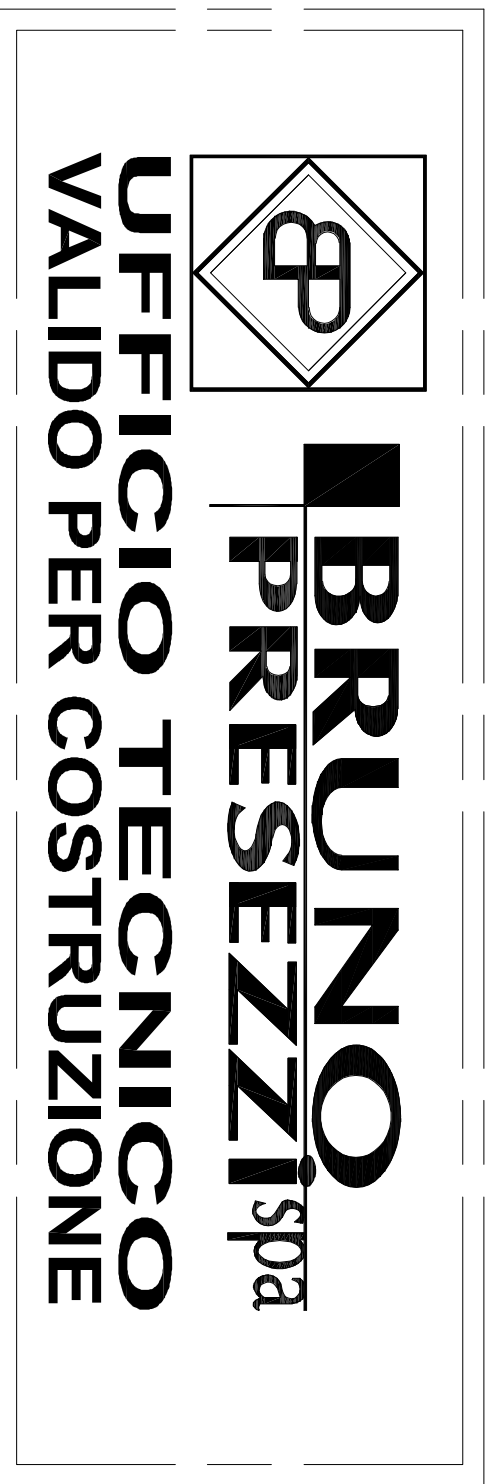
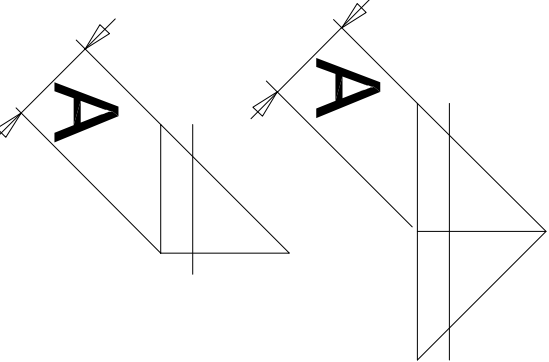

Q.tà		Q.TA'		DATA		COMMESSA N.		DIS. ASSIEME	
2	Plastrina	102	S275JR EN 10025	0,4					
1	Profilato UPN 80 - L=622 - UNI EN 10279	101	S275JR EN 10025	5,4					
Q.tà	Descrizione	Description	Pos.	Materiale	Numero Parte	Massa	RIC.	Descrizione:	
	S.P.	R.V.	R.V.	S275JR EN 10025	6,2 kg			Trave sostegno lamiera (Sheet metal support beam)	
	Disegnato	Verificato	Autorizzato	Materiale	Massa				
Disegno N.		60-26-00B-107		Scala: 1 : 5		Revisione: 0		Foglio: 1 di 1	
A		B		C		D		A	